

ACERBIS PARTS



A - (1 pcs.)



B - (2 pcs.)



D - (1 pcs.)



F - (1 pcs.)



O - (1 pcs.)



H - (4 pcs.)



I - (1 pcs.)



M - (1 pcs.)



C - (1 pcs.)



E - (1 pcs.)

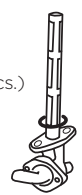

G - (2 pcs.)



N - (1 pcs.)



Q - (1 pcs.)



L - (1 pcs.)



P - (1 pcs.)

O.E.M ITEMS TO USE:



R - (1 pcs.)

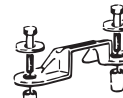

S - (1 pcs.)

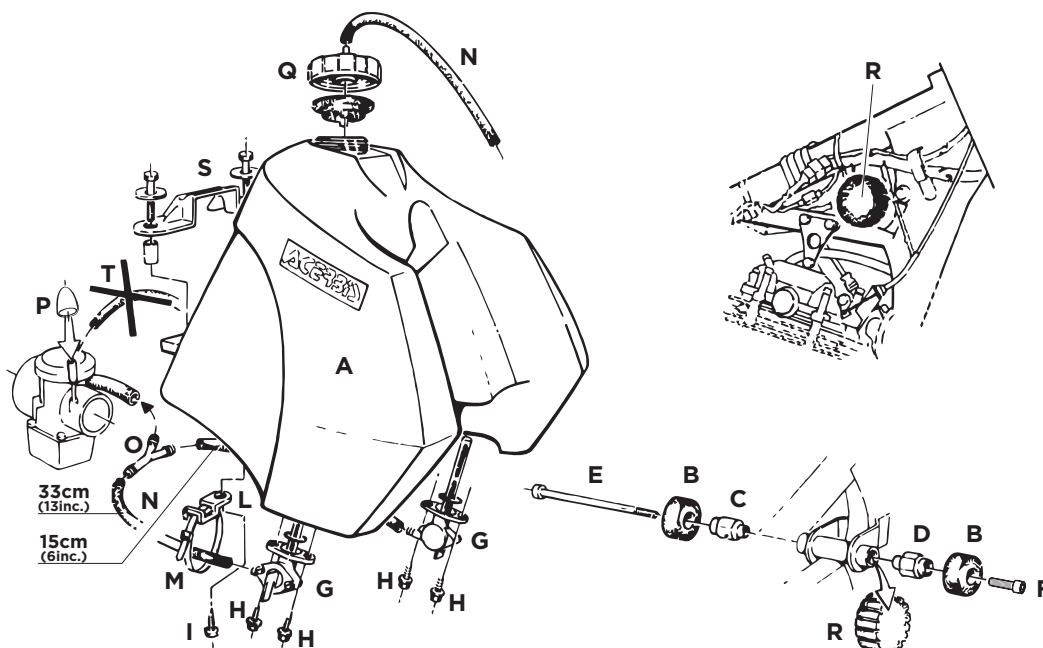

Smontare il serbatoio originale e togliere i supporti di gomma (R). Applicare al telaio i supporti di gomma (B) utilizzando il distanziale cilindrico (C) ed il distanziale esagonale (D), avvitando prima la vite (S), poi la vite (F) rispettando esattamente le posizioni indicate in figura. Applicare i rubinetti (G) con le guarnizioni e le viti (H). Montare il serbatoio ACERBIS riutilizzando la piastra (S) con le viti e le bussole originali come indicato in figura. Con la vite (I) fissare al serbatoio il particolare (L), inserendovi poi la fascetta (M), come in figura, e regolandola in modo che il tubo di gomma (N) possa scorrere liberamente. Collegare i rubinetti (G) al carburatore utilizzando il raccordo (O) ed il tubo di gomma (N) tagliato nelle misure indicate.

ATTENZIONE! Togliere dal carburatore il tubetto di gomma originale (T) e chiudere l'attacco per la depressione con il tappo (P) contenuto nel kit di montaggio.

Avvitare il tappo (Q) ed utilizzare il tubo di gomma (N) rimasto.

Remove the original tank and then rubber supports (R) from the frame. Install rubber supports (B) to the frame using the cylindrical spacer (C) and the hexagonal spacer (D), fastening bolt (E) and then bolt (F) strictly observing the positions shown in the drawing. Install petcocks (G) with gaskets and bolts (H). Install Acerbis tank with using plate (S) with original bolts and spacers as shown in the drawing. Fix part (L) to the tank with bolt (I), then insert clamp (M), as in the drawing and adjust it so that rubber tube (N) can freely slip. Connect petcocks (G) to the carburettor using fuel line (O) and rubber tube (N) cut in the indicated length.

ATTENTION! Remove the original rubber tube from carburettor (T) and close the connection for depression with cap (P) included in the mounting kit.

Fasten cap (Q) and use the remaining rubber tube (N).

WARNING!

Clean tank interior thoroughly before installation. install this fuel tank only in a well ventilated area, as gasoline fumes are extremely dangerous. do not start operate the vehicle if there are any fuel leaks! acerbis recommends that installation be done by licensed mechanic. read all instructions first before beginning installation.

ATTENZIONE!

pulire a fondo l'interno del serbatoio prima dell'installazione. svolgere l'operazione unicamente in un ambiente ventilato, poiché i fumi della benzina sono estremamente pericolosi. non avviare il veicolo se si riscontrano perdite di carburante! acerbis raccomanda l'installazione presso meccanici autorizzati. leggere attentamente le istruzioni prima di iniziare il montaggio.

DISCLAIMER:

DISCLAIMER: Due to uncontrolled variables in the manufacturing process of rotationally molded fuel tanks, the fuel tank may vary in size and shape by up to 7% of the manufacturer's original listed capacity.

LIBERATORIA

LIBERATORIA: A causa di variabili inponderabili nel processo di stampaggio rotazionale dei serbatoi, questi possono differire in forma e dimensioni fino al 7% rispetto alla capacità dichiarata.

**FOR COMPETITION USE ONLY
SOLO PER USO AGONISTICO**

ACERBIS®

Thank you for purchasing an ACERBIS fuel tank

WARNING

It is **EXTREMELY IMPORTANT** that the fuel tank be properly installed. To ensure proper installation, it is **STRONGLY RECOMMENDED** that the tank be installed only by a qualified OEM licensed dealership mechanic. Improper installation could result in serious injury or even death.

If self-installed NOTE THE FOLLOWING. Particular attention must be paid to excessive fuel line length and fuel line proximity to hot engine areas and pipes to prevent fire.

Clean tank interior thoroughly before installation. Install this fuel tank only in a well ventilated area, as gasoline fumes are extremely dangerous. Do not start or operate the vehicle if there are any fuel leaks! Read all instruction first before beginning installation.

DISCLAIMER

Due to uncontrolled variables in the manufacturing process of rotationally molded fuel tanks, the fuel tank may vary in size and shape by up to 7% of the manufacturer's original listed capacity.